

EPA Recognized* and ETV Tested

D-LEAD[®] PROFESSIONAL PAINT TEST KIT

Part #: PKIT-24-1.0



Instructions

**Preparation
Collecting Samples
Testing
Results
Disposal**

**Before using this Paint Test Kit read
these detailed instructions**

Patent Pending

ESCA TECH, INC.
Contamination Control Systems,
Services & Solutions

3747 N. Booth St. Milwaukee, WI 53212 USA

T: (414) 962-3006, (877) 877-6590

F: (414) 962-7003

rrp@esca-tech.com

www.esca-tech.com

Information

This kit contains 24 tests for lead in paint.

The D-Lead® Paint Test quickly and simply determines if a paint sample contains more or less than the USEPA Limit of 1.0 mg/cm² of lead.

WARNING! If you scrape, sand or remove old paint, you may release lead dust. LEAD IS TOXIC, EXPOSURE TO LEAD DUST CAN CAUSE SERIOUS ILLNESS, SUCH AS BRAIN DAMAGE, ESPECIALLY IN CHILDREN. PREGNANT WOMAN SHOULD ALSO AVOID EXPOSURE. If lead based paint is present on an affected surface, then lead safe work practices described in the EPA Renovation, Repair and Painting Rule must be used. Before you start, find out how to protect yourself and your family by contacting the National Lead Information Hotline at 1-800-424-LEAD or log www.epa.gov/lead.

Solution 1: CAUTION: IRRITANT.

Contains: Sodium Hydroxide. Avoid contact with eyes and skin. Do not ingest. In case of eye contact, flush with water for 15 minutes and get medical attention. In case of skin contact, wash thoroughly with soap and water. If swallowed, contact physician. Keep Out Of Reach Of Children.

Solution 2: WARNING: FLAMMABLE. IRRITANT.

Contains: Ammonium Sulfide. Keep away from heat, sparks and flames. Avoid contact with eyes and skin. Avoid breathing vapors. Do not ingest. In case of eye contact, flush with water for 15 minutes and get medical attention. In case of skin contact, wash thoroughly with soap and water. If irritation persists, get medical attention. If swallowed, drink one or two glasses of water and contact physician. Keep Out Of Reach Of Children.

When you use this test kit, eye protection and gloves are recommended.

Storage

The D-Lead® Paint Test Kit should be stored at temperatures below 90 °F (32 °C), out of direct sunlight and away from extreme heat. Note: If Solutions freeze, allow to thaw before use.

Overview

The D-Lead® Paint Test Kit will detect lead in paint by a simple color change in 3 -13 minutes.

The Test Standard for this kit has been set at 1.0 mg/cm².

Basis of Test

A 3/16" diameter paint sample is collected.

Proper sample size is essential for consistent results.

The entire sample is placed in Solution 1 (bottle 1).

When 5 drops of Solution 2 (bottle 2) is added, any lead present will cause a color change.

The only known interference is Mercury Oxide.

Warranty: The D-Lead® Paint Test Kit provides a quick and convenient test for the presence of lead at the USEPA Limit of 1.0 mg/cm². Under laboratory conditions this test kit reliably detects for the presence of lead in paint samples when used according to the directions. EXCEPT AS MAY BE EXPRESSLY SET FORTH HEREIN, PURCHASER ACKNOWLEDGES AND AGREES THAT THERE ARE NO OTHER WARRANTIES, GUARANTEES, CONDITIONS, COVENANTS OR REPRESENTATIONS BY MANUFACTUER OR DISTRIBUTOR AS TO MARKETABILITY, MERCHANTABILITY, FITNESS FOR A PARTICULAR PURPOSE OR OTHER ATTRIBUTES, WHETHER EXPRESS OR IMPLIED (IN LAW OR IN FACT), ORAL OR WRITTEN.

Liability: The manufacturer assumes no liability for the misuse of the D-Lead® Paint Test Kit or for the interpretation of the results by the user. Manufacturer's liability is limited to the refund of the purchase price.

Contents

Test Standard



Solution 1 bottle (24)



Solution 2 bottle (1)



Individually wrapped D-Wipe® Towels (25)



Sample Catch Trays (25)

Cleaning Rod (1)



Scoring Tool (1)
(Sampling tool)



Razor Blade with handle (1)



Waste Disposal Bag

Sample gloves, eye protection and hammer not included.

Preparation

1. Select sample location.
2. Write sample number on the cap of the bottle of Test Solution 1.
3. Record sample data on your recordkeeping form.
4. Fold one Sample Catch Tray along the fold lines.



Fold Sample Catch Tray



5. Put on a clean pair of sample gloves.
6. Clean the Scoring Tool, Cleaning Rod and Razor Blade.
7. Then fold the dirty side in and clean the area to be sampled with a D-Wipe® Towel.



Clean sample area

Clean Scoring Tool, Cleaning Rod and Razor Blade

Clean inside

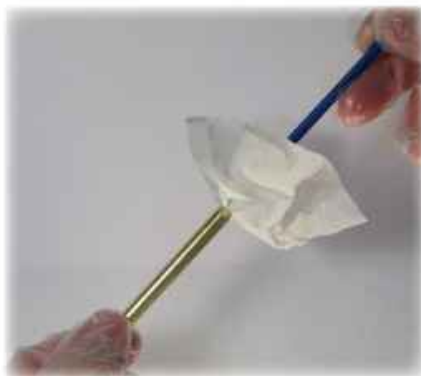

Clean outside



Collecting Samples

It is important to minimize the amount of substrate (wood, plaster etc.) transferred with the paint.

1. For horizontal surfaces (picture 1) the Sample Catch Tray is placed next to the sample and used like a dustpan to collect all the paint chips (picture 6).
2. Vertical Sample: Use adhesive edge to attach folded Sample Catch Tray directly below the sample area to catch all the paint chips (picture 2).
3. Lightly tap the Scoring Tool with a hammer for a good cut line on all layers (picture 3).
4. If hammer is not available press and twist the sample Scoring Tool to cut through all of the paint layers (picture 1, 2).
5. With Razor Blade score the paint within the circle 2 times in each direction (picture 4, 5).

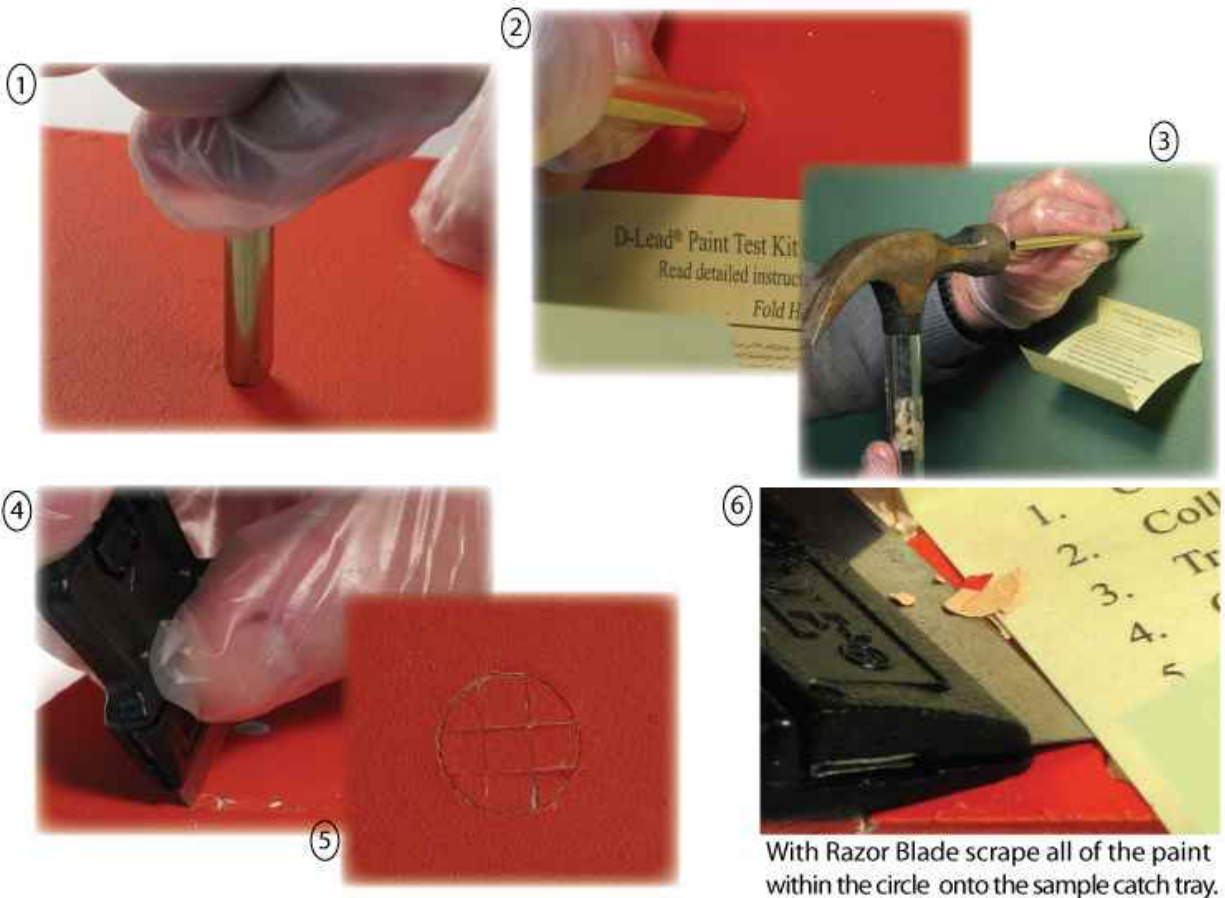

With Razor Blade scrape all of the paint within the circle onto the sample catch tray.



If the entire sample is lifted by the Scoring Tool, then use the Cleaning Rod to push the sample onto the Sample Catch Tray.

Cut sample into 4 pieces for faster results.

Testing

1. It is essential that all of the paint within the circle scribed by the Scoring Tool is transferred to a new bottle of **Test Solution 1** for accurate results.
2. If any piece of the sample is lost before transfer to bottle of **Test Solution 1**, you should collect a new sample.
3. Never put more or less than one entire sample into the bottle of **Test Solution 1**.

1. Transfer all of the paint sample to a fresh bottle of **Test Solution 1**, close cap and shake for 10 seconds.



2. Add 5 drops of **Test Solution 2** to the bottle of **Test Solution 1** containing sample, close. Shake 10 seconds.

Look through the bottle Viewing Window. Compare the Test Solution color to the Test Standard printed above the Viewing Window.



Important



If a faint yellow color develops after adding sample to the bottle of Solution 1, it means Chromate is present in the sample. This is not a positive test for lead. Not all Chromates contain lead. Proceed with the test.

Caution

When viewing through the Viewing Window, background colors and shapes may make it difficult to compare the Test Solution to the Test Standard. View against a well lit white background (e.g. white paper) to compare the Test Solution to the Test Standard.



Results

To determine the lead concentration, the Test Solution is compared to the Test Standard.

1. Once the paint sample is added to the bottle of Solution 1, the test must proceed within 5 minutes. If the paint sample sits more than 5 minutes in the bottle before solution 2 is added discard test. Start a new test with a new bottle of Solution 1 and a fresh paint sample.
2. Once Solution 2 is added to the bottle of Solution 1, the test must be determined within 20 minutes. If sample sits more than 20 minutes after Solution 2 is added, the color change can no longer be determined correctly and a new sample should be collected and tested.

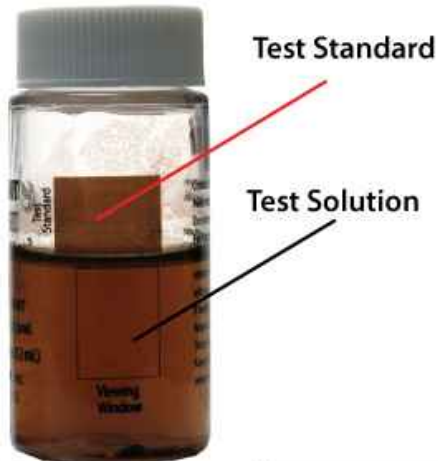

If the Test Solution is **DARKER** than the Test Standard, the test is **POSITIVE**. Standard. Test is complete, record results.



If the Test Solution is **LIGHTER** than the Test Standard, wait 10 minutes. Then shake the bottle for 10 seconds, compare to the Test Standard again.

If the Test Solution is still **LIGHTER** than the Test Standard, test is **NEGATIVE**. If the Test Solution is **DARKER** or the **SAME** as the Test Standard, the test is **POSITIVE**. Test is complete, record results.

Examples



Important

1. Use only the Test Standard printed on the bottle of Test Solution 1 to determine test results.
2. When interpreting test results some color variations may occur, observe only if the sample is **LIGHTER** or **DARKER** than the Test Standard and ignore variations in color.

Disposal



Paint Test Kit Waste Disposal Bag with Absorbent and Neutralizer



- Neutralizes Test Solutions
- Binds Lead

For non-hazardous disposal

After a test is done, pour used D-Lead® Paint Test Solution 1 into waste absorbent. Then add to the Waste Disposal Bag the open bottle and cap, used D-Wipe® Towel and Sample Catch Tray.

After all the tests are done pour any remaining D-Lead® Paint Test Solution 2 into this bag.

Then place the open bottle and cap of the D-Lead® Paint Test Solution 2 into this bag. Then seal the bag and dispose in accordance with all local, state and federal regulations.



The Absorbents in the D-Lead® Paint Test Kit Waste Disposal Bag will neutralize the test solutions and bind the lead for safe disposal as non-hazardous waste.

D-Wipe® Towel packaging and used gloves can be placed in the trash.

For more information contact



3747 N. Booth St. Milwaukee, WI 53212 USA

T: (414) 962-3006, (877) 877-6590

F: (414) 962-7003

rrp@esca-tech.com

www.esca-tech.com